

Castle Peak Meeting Rooms (2nd Floor)

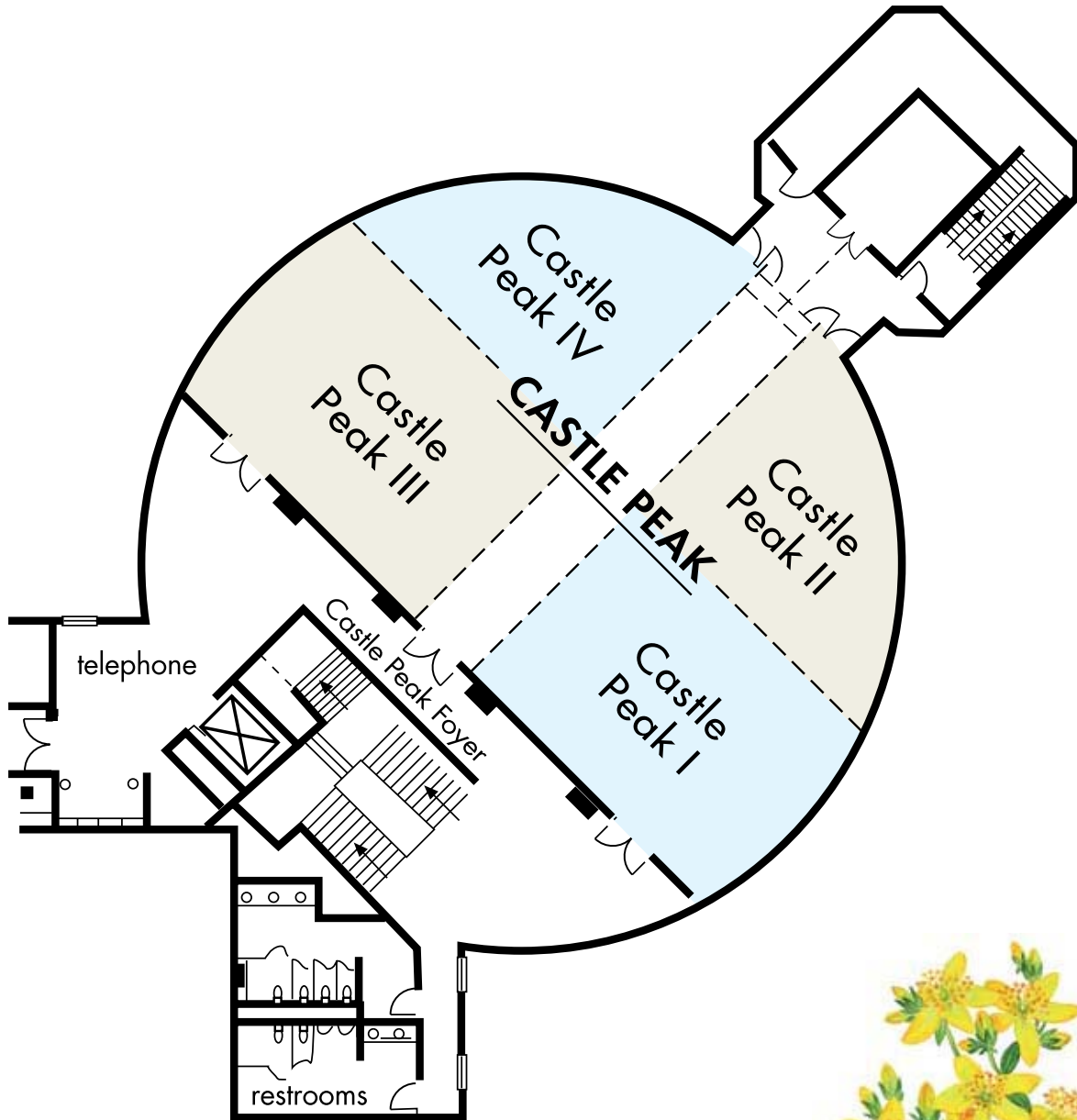

	Square Footage	Dimensions LxWxH	Theater	Schoolroom	Conference	Hollow Square	U-Shape	Reception	Dining Rounds of 12 people
CASTLE PEAK	3950	ROUND	400	176	X	X	X	400	324
CASTLE PEAK I	1000	25X37X9'10	120	45	36	36	30	120	72
CASTLE PEAK II	700	23X34X9'10	60	24	20	24	20	60	48
CASTLE PEAK III	1000	25X37X9'10	120	45	36	36	30	120	72
CASTLE PEAK IV	700	23X34X9'10	60	24	20	24	20	60	48
CASTLE PEAK FOYER	1350	X	X	X	X	X	X	130	X
BELVEDERE	3950	X	X	X	X	X	X	400	288
BOARDROOM	480	X	X	X	16	X	X	X	X

Boardroom/Rooftop Patio, Belvedere (3rd Floor)

