

## Keystone Lodge & Spa Ballroom (3rd Floor)

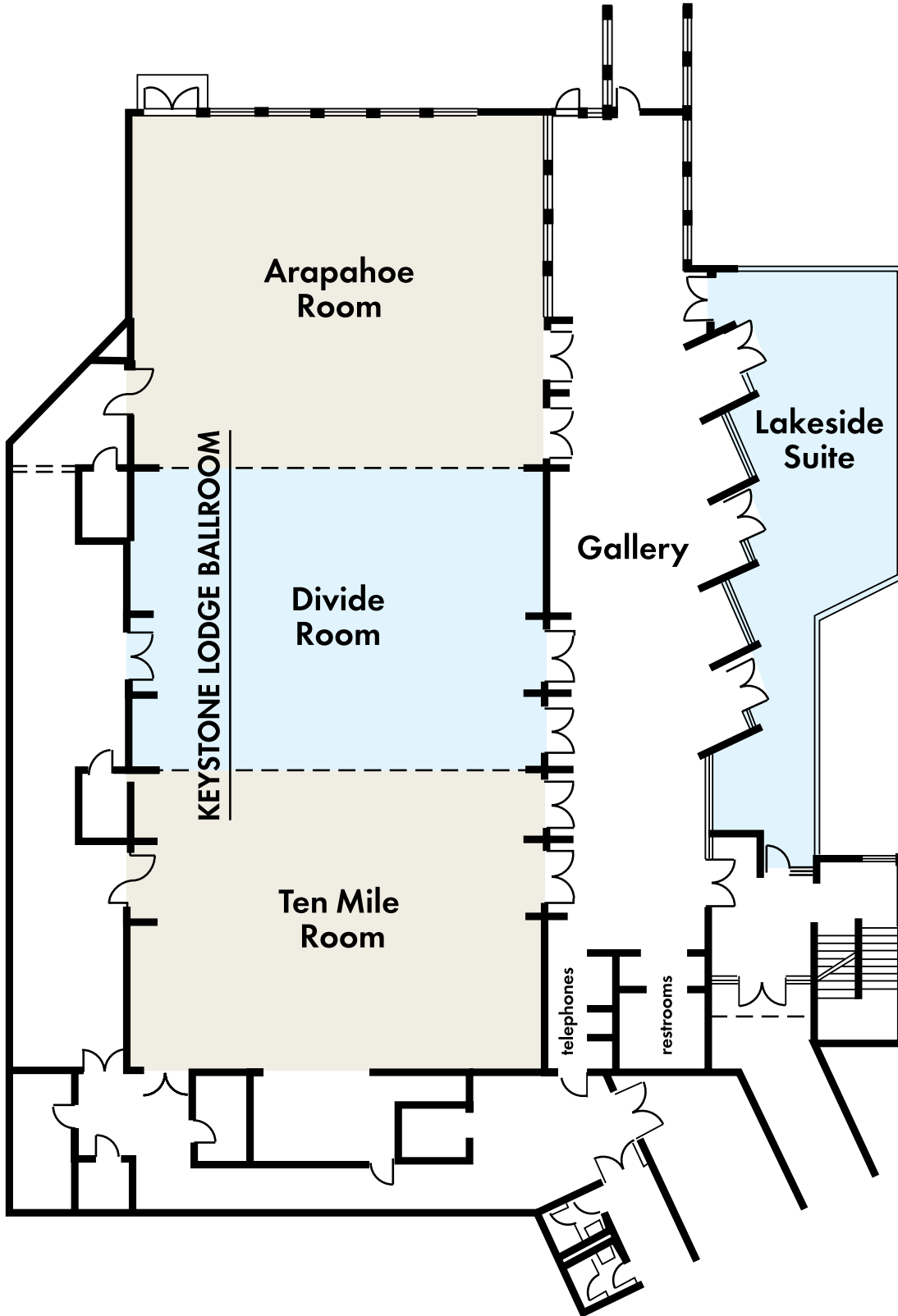

	Square Footage	Dimensions LxWxH	Theater	Schoolroom	Conference	Hollow Square	U-Shape	Reception	Dining Rounds of 12 people
<b>KEYSTONE LODGE &amp; SPA BALLROOM</b>	<b>5700</b>	<b>114X50X13-15'5</b>	<b>578</b>	<b>324</b>	<b>X</b>	<b>X</b>	<b>X</b>	<b>630</b>	<b>480</b>
<b>ARAPAHOE ROOM</b>	2100	50X42X15'5	240	120	30	64	48	250	168
<b>DIVIDE ROOM</b>	1800	50X36X13	180	96	30	58	42	190	144
<b>TEN MILE ROOM</b>	1800	50X36X13	180	96	30	58	42	190	144
<b>GALLERY</b>	1700	100X12X12	X	X	X	X	X	130	X
<b>LAKESIDE SUITE</b>	630	39X16X12	40	25	20	20	20	75	48
<b>MOUNTAIN VIEW TERRACE</b>	2000	50X40	80	X	X	X	X	120	96
<b>GAZEBO</b>	2116	93X23	200	X	X	X	X	X	168
<b>LODGE TERRACE DECK</b>	5015	85X89	X	X	X	X	X	X	336

